

## Features

---

- Worship area; multi-purpose hall
- meeting / breakout rooms
- activity area
- internal toilets incl disabled
- on-site parking for 50 vehicles
- ramp access
- air conditioning to main rooms
- organ & piano
- sound system, including T-loop function
- large kitchen
- data projector in worship area

## Notes

---

- kitchen use includes
    - crockery / cutlery
    - stove / oven / microwave
    - refrigerator
    - multiple serveries
  - no alcohol permitted on premises
  - no smoking inside or around undercover areas
  - copyright regulations on pre-recorded media presentations apply to users
  - insurance required by all users – details on booking sheet
- 
- operating hours 0800 – 2200 daily

## About us

---

The people of the Thornleigh Hillcrest congregation have built this complex to share with the community in which they reside.

As a Christian community we are committed to:

- Lord Jesus Christ
- nurturing the young
- worship & fellowship
- family life & values
- pastoral care
- Christian education
- social responsibility
- mission & evangelism

As a community we worship regularly and we share our faith through fellowship and social interaction. Across the life of our congregation all age groups are catered for in one way or another.

You will find opportunity for interaction through Bible study, getting together with likeminded people, Christian education pursuits, social responsibility focus and outreach through mission and evangelistic avenues.

We are a caring community with a full range of pastoral services.

Our life as a community includes activities such as, Mingles (marrieds and singles), fellowship groups, Bible study groups across various ages and human and community interest groups.

For more information about our community, please contact the minister on 0402478240



*Thornleigh hillcrest  
Congregation*

*Church & Community complex*



*1-3 Paling St, Thornleigh, NSW  
(road access via Paling St)*

---

*Facilities available for use*

*Contact Booking Manager*

*Telephone 04 14632030*

*Email; [bookings@thornleigh-hillcrestuca.org.au](mailto:bookings@thornleigh-hillcrestuca.org.au)*

---

# Thornleigh Hillcrest Uniting Church

## Layout of Church & Community Complex

Area	Seating
1 Worship area	250
2 Foyer	
3 Multipurpose	120
4 Kitchen	
5 Meeting	8
6 Ministers office	
7a Heritage room	8
7b Preschool store	
8 Preschool	
9 Preschool office	
10 Church office	
11 Meeting (downstairs)	20

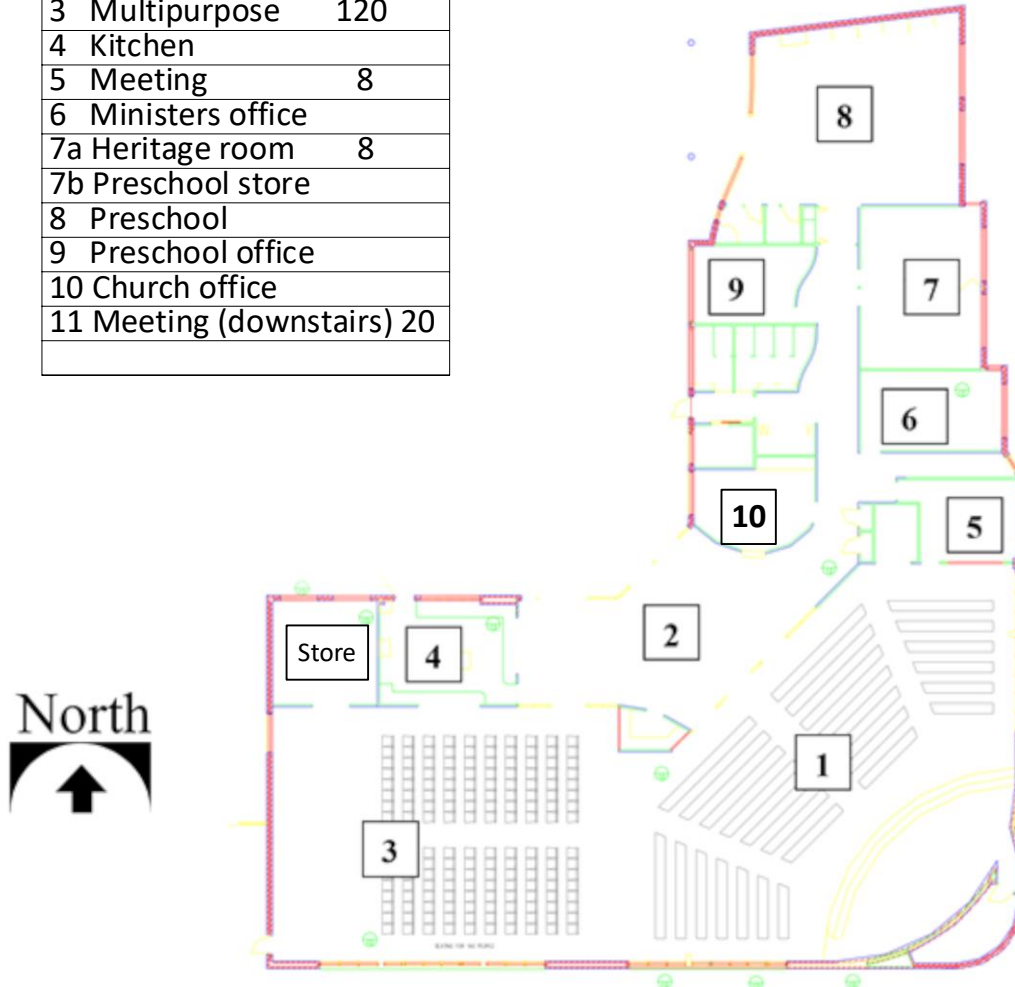

### How to find us

#### Coming by road:

We are 5km from Hornsby, 10km from Parramatta, 24 km from Sydney central, 39 km from Sydney airport via M1 & M2 tollroads



#### Coming by train:

Alight at Thornleigh Station east side; cross Pennant Hills Road overbridge; 200m walk south.

#### Locality map

